

# Arrangements

## PRACTICE EXERCISE

### Level - 1

**Directions for questions 1 to 3:** Answer the following questions based on the given information.

Two of Anand, Sanjay and Vivek are fighting with each other. The additional information is given below:

- The shorter between Anand and Sanjay is older of the two fighters.
- The younger between Sanjay and Vivek is shorter of the two fighters.
- The taller between Anand and Vivek is younger of the two fighters.

1. Who is not fighting?

- (a) Vivek (b) Sanjay  
(c) Anand (d) Either (a) or (b)  
(e) Data Insufficient

2. Who is the oldest among them?

- (a) Vivek (b) Sanjay  
(c) Anand (d) Either (b) or (c)  
(e) Data Insufficient

3. Who is the tallest among them?

- (a) Vivek (b) Sanjay  
(c) Anand (d) Either (a) or (c)  
(e) Data Insufficient

**Directions for question 4 to 6:** Answer the questions on the basis of the information given below:

The MotoGP race was organized in the mid of May 2007. There are only 4 participants in the race namely Mika Kallio, Mattia Passini, Alex Debon and Yuki Takahashi. The race consisted of four laps; Lap-1, Lap-2, Lap-3 and Lap-4. Each of the four participants finished each of the lap at a different position. At the end of Lap-4 Mika Kallio completed the race first, followed by Yuki Takahashi, Mattia Passini and Alex Debon in that order. The winner of Lap-1, Lap-2 and Lap-3 were Mattia Passini, Yuki Takahashi and Alex Debon respectively.

4. If Debon finished Lap-2 at 3rd position and Passini finished Lap-3 at 4th position then at what position Takahashi finished Lap-3?

- (a) 1st (b) 2nd  
(c) 3rd (d) 4th  
(e) Cannot be determined

5. If Passini finished Lap-3 at 2nd position and Kallio finished Lap-1 at 3rd position then at what position Debon finished Lap-1?

- (a) 1st (b) 2nd  
(c) 3rd (d) 4th  
(e) Cannot be determined

6. If Takahashi finished Lap-1 at 3rd position and Passini finished Lap-3 at 2nd position then at what position Kallio finished Lap-3?

- (a) 1st (b) 2nd  
(c) 3rd (d) 4th  
(e) Cannot be determined

**Direction for questions 7 to 12:** Answer the questions based on the information given below.

Raksha is younger than Saksha and older than Sita. Anju is younger than Manju and older than Sanju. Manju is younger than Sita and older than Jugal. Jugal is younger than Sanju and older than Mughal. Saksha is younger than Beena and older than Heena. Heena is older than Raksha.

7. Who is the youngest?

- (a) Anju (b) Sanju  
(c) Jugal (d) Mughal  
(e) Raksha

8. Who precedes Sanju, Jugal and Mughal in age?

- (a) Manju (b) Sita  
(c) Anju (d) Raksha  
(e) Cannot be determined

9. Who is the oldest?

- (a) Anju (b) Sanju  
(c) Beena (d) Sita  
(e) Heena

10. Who is next in age to Beena, Saksha, Raksha and Heena and Sita?

- (a) Manju  
(b) Sanju  
(c) Mughal  
(d) Anju  
(e) Cannot be determined

11. Who is the second oldest?  
 (a) Sanju (b) Beena  
 (c) Heena (d) Jugal  
 (e) Saksha
12. Who is the second youngest?  
 (a) Heena (b) Jugal  
 (c) Anju (d) Manju  
 (e) Saksha

### Level - 2

**Directions for questions 13 to 16:** Study the data and answer the questions that follow.

Only five persons namely Kally, Loyd, Micheal, Nanzo and Phelps participated in the racing contest in school. While the judges were finalising the ranks, Amy, Barbie, Cathrene and Dolly who had been watching the contest, commented as follows :

Cathrene said: "Nanzo will not be the third. Micheal will be the first."

Barbiesaid: "Nanzo will be the third. Nanzo will get a lower rank than Loyd."

Amy said: "Kally will be the second. Loyd will be the last."  
 Dolly said : "Loyd will be the last, if and only if Micheal is not the first."

In the end Dolly and one (and only one) statement of each of Amy, Barbie and Cathrene were proven correct. Each of the competitors got a different rank.

13. Who won the contest?  
 (a) Kally (b) Loyd  
 (c) Micheal (d) Nanzo  
 (e) Cannot be determined
14. Who ranked below Loyd?  
 (a) Micheal (b) Kally  
 (c) Nanzo (d) Phelps  
 (e) Cannot be determined
15. Who ranked above Nanzo?  
 (a) Micheal and Kally (b) Kally and Loyd  
 (c) Nanzo and Phelps (d) Micheal and Phelps  
 (e) Micheal and Loyd.
16. The number of persons ranking above Kally is /are :  
 (a) 0 (b) 1  
 (c) 2 (d) 3  
 (e) Cannot be determined

**Direction for questions 17 to 21:** Answer the questions based on the data given below.

A, B, C and D each lives in an apartment.

1. Their apartments are arranged linearly as

shown: 

I	II	III	IV
---	----	-----	----

 —————> East

2. One of the four is the landlord.

3. If C's apartment is not next to B's apartment, then the landlord is A and lives in apartment I.
4. If A's apartment is east of C's apartment, then the landlord is D and lives in apartment I.
5. If B's apartment is not next to D's apartment, then the landlord is C and lives in apartment III.
6. If A's apartment is east of D's apartment, then the landlord is B and lives in apartment II.
17. Who is the landlord?  
 (a) D (b) C  
 (c) B (d) A  
 (e) Cannot be determined
18. Who stays in apartment IV?  
 (a) D (b) C  
 (c) B (d) A  
 (e) Cannot be determined
19. Who stays to the west of D?  
 (a) A (b) B  
 (c) C (d) A or B  
 (e) B or C
20. The only person to stay in an apartment with same numbering as his name order in the English alphabet is  
 (a) A and B. (b) B and C.  
 (c) C and D. (d) All of these.  
 (e) Cannot be determined
21. The person residing in apartment II stays between  
 (a) D and C. (b) A and C.  
 (c) C and B. (d) D and A.  
 (e) A and B

**Directions for questions 22 to 26:** Read the information given below and answer the questions that follows.

Eight friends A, B, C, D, E, F, G and H, each one having a different profession, is sitting around a round table. They are sitting in such a manner that there is a person sitting exactly opposite to each of them. Their professions are engineer, doctor, author, teacher, student, IAS, politician and cricketer (not necessarily in the given order). Their seating arrangements is subject to the following constraints:

- (i) Cricketer and teacher are sitting exactly opposite to each other.
- (ii) Harris, a teacher, is sitting to the immediate left of the politician.
- (iii) E, a student, is sitting to the immediate right of the IAS.
- (iv) A is sitting two places to the left of politician G.
- (v) C, an author, is sitting in between B and D.
- (vi) Engineer is sitting in the third place to the right of D.
- (vii) B, a doctor, and F are sitting at equal distance from the cricketer.



22. Who is the IAS?  
 (a) F (b) A  
 (c) E (d) Either (1) or (2)  
 (e) Cannot be determined
23. Who is sitting exactly opposite to the engineer?  
 (a) IAS (b) Author  
 (c) D (d) Student  
 (e) None of these
24. The profession of Dick is:  
 (a) IAS (b) Teacher  
 (c) Cricketer (d) Student  
 (e) Cannot be determined
25. Who is sitting exactly opposite to the politician?  
 (a) Teacher (b) Student  
 (c) F (d) Author  
 (e) Cannot be determined
26. How many different arrangements are possible?  
 (a) 1 (b) 2  
 (c) 3 (d) 4  
 (e) more than 4

### Level - 3

**Direction for questions 27 to 29 :** These questions are based on the following information.

Five of India's leading models are posing for a photograph promoting "y'know, world peace and understanding". But then, Rakesh Shreshtha the photographer is having a tough time getting them to stand in a straight line, because Aishwarya refuses to

stand next to Sushmita because Sushmita had said something about her in a leading gossip magazine. Rachel and Anu want to stand together because they are "such good friends," y'know. Manpreet on the other hand cannot get along well with Rachel, because there is some talk about Rachel scheming to get a contract already awarded to Manpreet. Anu believes her friendly astrologer who has asked her to stand at the extreme right for all group photographs. Finally, Rakesh managed to pacify the girls and got a beautiful picture of five beautiful girls smiling beautifully in a beautiful straight line, promoting world peace.

27. If Aishwarya is standing to the extreme left, which is the girl standing in the middle?  
 (a) Manpreet (b) Sushmita  
 (c) Rachel (d) Anu  
 (e) Cannot be determined
28. If Aishwarya stands to the extreme left, which is the girl who stands second from left?  
 (a) Anu (b) Sushmita  
 (c) Rachel (d) Manpreet  
 (e) Cannot be determined
29. If Anu's astrologer tells her to stand second from left and Aishwarya decides to stand second from right, then who is the girl standing on the extreme right?  
 (a) Rachel (b) Sushmita  
 (c) Manpreet (d) Either (a) or (b)  
 (e) Either (a) or (c)

## ANSWERS

- |         |         |         |         |         |         |         |         |         |         |
|---------|---------|---------|---------|---------|---------|---------|---------|---------|---------|
| 1. (a)  | 2. (b)  | 3. (a)  | 4. (c)  | 5. (b)  | 6. (c)  | 7. (d)  | 8. (c)  | 9. (c)  | 10. (a) |
| 11. (e) | 12. (b) | 13. (c) | 14. (d) | 15. (a) | 16. (b) | 17. (d) | 18. (c) | 19. (a) | 20. (b) |
| 21. (c) | 22. (a) | 23. (d) | 24. (c) | 25. (d) | 26. (a) | 27. (b) | 28. (d) | 29. (c) |         |

## SOLUTIONS

### Level - 1

**For questions 1 to 3:**

This question has to be solved with hit and trial. First take a combination of age alone and if it satisfies all the three conditions, then test it for height as well. For e.g. Anand is the eldest in the group followed by Sanjay who in turn is followed by Vivek. Also let's say Anand and Sanjay are fighting. According to the first statement, Sanjay is one of the fighters. (And the

second fighter has to be Anand) According to the second statement, Sanjay is the other fighter. According to the third statement, Anand should be the younger fighter but our assumption does not support it, so we have to try different combination. When we take Sanjay as the oldest followed by Anand and then by Vivek, we satisfy all the conditions.

1. a Vivek is not fighting.
2. b Sanjay is the oldest.

3. a Vivek is the tallest.

**For questions 4 to 6:** The given information can be tabulated as:

Lap - 1	Lap - 2	Lap - 3	Lap-4
Passini	Takahashi	Debon	Kallio
			Takahashi
			Passini
			Debon

4. c

5. b

6. c

**For questions 7 to 12 :**

In ascending order:

I. Sita, Raksha, Saksha

II. Sanju, Anju, Manju

III. Jugal, Manju, Sita

IV. Mughal, Jugal, Sanju

V. Raksha, Heena, Saksha, Beena

In ascending order of ages, we get

Mughal, Jugal, Sanju, Anju, Manju, Sita, Raksha, Heena, Saksha, Beena.

7. d      8. c      9. c      10. a

11. e      12. b

## Level - 2

**For questions 13 to 16 :**

Taking Dolly's statement as correct, there are 2 possibilities.

i. Loyd is last and Michael is not first.

ii. Michael is first and Loyd is not last.

**Considering case – 1**

Statement – I

Second part is incorrect so first part is correct i.e. Nanzo will not be third

Statement – II

First part as well as second part is incorrect so case 1 is not possible.

**Considering case – 2**

Statement – I

Second part is correct and first part is incorrect so Nanzo will be third.

Statement – II

First part is correct so second part is incorrect i.e. Nanzo will get a rank higher than Loyd.

Statement – III

Second part is incorrect so first part is correct i.e. Kally is second.

If Loyd is not at the last position, he will be fourth. So the sequence from first to fifth is Michael, Kally, Nanzo, Loyd, Phelps

13. c

14. d

15. a

16. b

17. d From the observation we have found that product BN didnot deteriorate between 1993 and 1994.

18. c Product BN in Kolkata and product MT in Delhi had doubled their market share.

19. a MT in Calcutta decreases from 25 to 10 = 60%.

20. b City where thhe number of products losing minimum number of market share between 1993 and 1994 is Kolkata.

21. c Number of products which has a 100% market share in the four metros was 2, namely, HD and BN.

**For questions 22 to 26 :**

Using condition (i) and (vii), we can infer that F is neither a teacher nor a cricketer. Also, they are sitting equidistant from each other. Further, using all the conditions except (i) we can conclude that D is a cricketer. Now, using the position of D we can place rest of the friends as given in the diagram below.

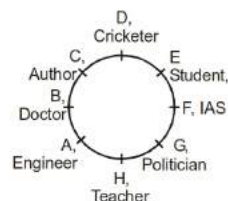

22. a

23. d

24. c

25. d

26. a

## Level - 3

27. b If Aishwarya is standing at the extreme left, the latter arrangement holds good. Hence, it is Sushmita who is standing in the middle.

28. d Again the latter arrangement holds good. So, the girl who is standing second from left is Manpreet.

29. c Under the given condition, following arrangement is possible:

Left				Right
Sushmita	Anu	Rachel	Aishwarya	Manpreet
1	2	3	4	5

Hence, Manpreet is standing on the extreme right.



## PREVIOUS YEARS QUESTIONS

### LEVEL - 1

**1994**

**Directions for Questions 1 to 4:** Study the information below and answer the questions based on it.

A, B, C, D, E, F and G are brothers. Two brothers had an argument and A said to B "You are as old as C was when I was twice as old as D, and will be as old as E was when he was as old as C is now". B said to A "You may be older than F but G is as old as I was when you were as old as G is, and D will be as old as F was when F will be as old as G is".

- Who is the eldest brother?  
(a) A (b) E  
(c) C (d) Cannot be determined
- Who is the youngest brother?  
(a) B  
(b) D  
(c) F  
(d) Cannot be determined
- Which two are probably twins?  
(a) D and G  
(b) E and C  
(c) A and B  
(d) Cannot be determined
- Which of the following is false?  
(a) G has 4 elder brothers.  
(b) A is older than G but younger than E.  
(c) B has three elder brothers.  
(d) There is a pair of twins among the brothers.

**1998**

**Directions for Questions 5 to 7:** Answer the questions based on the following information.

A, B, C and D are to be seated in a row. But C and D cannot be together. Also B cannot be at the third place.

- Which of the following must be false?  
(a) A is at the first place  
(b) A is at the second place  
(c) A is at the third place  
(d) A is at the fourth place
- If A is not at the third place, then which of the following options does C have?  
(a) The first place only  
(b) The third place only  
(c) The first and third place only  
(d) Any of the places

- If A and B are together, then which of the following must be necessarily true?

- (a) C is not at the first place
- (b) A is at the third place
- (c) D is at the first place
- (d) C is at the first place

**1999**

- Abraham, Border, Charlie, Dennis and Elmer, and their respective wives recently dined together and were seated at a circular table. The seats were so arranged that men and women alternated and each woman was three places away from her husband. Mrs Charlie sat to the left of Mr Abraham. Mrs Elmer sat two places to the right of Mrs Border. Who sat to the right of Mr Abraham?

- (a) Mrs Dennis
- (b) Mrs Elmer
- (c) Mrs Border
- (d) Mrs Border or Mrs Dennis

**Directions for Questions 9 and 10:** Answer the questions based on the following information.

Seven university cricket players are to be honoured at a special luncheon. The players will be seated on the dais along one side of a single rectangular table.

- A and G have to leave the luncheon early and must be seated at the extreme right end of the table, which is closest to the exit.
  - B will receive the Man of the Match Award and must be in the centre chair.
  - C and D who are bitter rivals for the position of wicketkeeper, dislike one another and should be seated as far apart as possible.
  - E and F are best friends and want to sit together.
- Which of the following may not be seated at either end of the table?

- (a) C (b) D
- (c) G (d) F

- Which of the following pairs may not be seated together?

- (a) E and A (b) B and D
- (c) C and F (d) G and D

**2000**

- Persons X, Y, Z and Q live in red, green, yellow or blue-coloured houses placed in a sequence on a street. Z lives in a yellow house. The green house is adjacent to the blue house. X does not live adjacent to Z. The yellow house is in between the green and red houses. The colour of the house, X lives in is

- (a) blue
- (b) green
- (c) red
- (d) Not possible to determine

### 2001

**Directions for Questions 12 and 13:** Answer the following questions based on the information given below.

Elle is three times older than Yogesh. Zaheer is half the age of Wahida. Yogesh is older than Zaheer.

12. Which of the following can be inferred?
- (a) Yogesh is older than Wahida
  - (b) Elle is older than Wahida
  - (c) Elle may be younger than Wahida
  - (d) None of these
13. Which of the following information will be sufficient to estimate Elle's age?
- (a) Zaheer is 10-year-old
  - (b) Both Yogesh and Wahida are older than Zaheer by the same number of years
  - (c) Both (a) and (b)
  - (d) None of these

### 2002

14. Six persons are playing a card game. Suresh is facing Raghubir who is to the left of Ajay and to the right of Pramod. Ajay is to the left of Dhiraj. Yogendra is to the left of Pramod. If Dhiraj exchanges his seat with Yogendra and Pramod exchanges with Raghubir, who will be sitting to the left of Dhiraj?
- (a) Yogendra
  - (b) Raghubir
  - (c) Suresh
  - (d) Ajay

## LEVEL - 2

### 1994

**Directions for Questions 15 to 18:** Study the information below and answer questions based on it.

A leading socialite decided to organize a dinner and invited a few of her friends. Only the host and the hostess were sitting at the opposite ends of a rectangular table, with three persons along each side. The pre-requisite for the seating arrangement was that each person must be seated such that atleast on one side it has a person of opposite sex. Maqbool is opposite Shobha, who is not the hostess. Ratan has a woman on his right and is sitting opposite a woman. Monisha is sitting to the hostess's right, next to Dhirubhai. One person is seated between Madhuri and Urmila who is not the hostess. The men were Maqbool, Ratan, Dhirubhai and Jackie,

while the women were Madhuri, Urmila, Shobha and Monisha.

15. The eighth person present, Jackie, must be
- I. the host
  - II. Seated to Shobha's right
  - III. Seated opposite Urmila
- (a) I only
  - (b) III only
  - (c) I and II only
  - (d) II and III only
16. Which of the following persons is definitely not seated next to a person of the same sex?
- (a) Maqbool
  - (b) Madhuri
  - (c) Jackie
  - (d) Shobha
17. If Ratan would have exchanged seats with a person four places to his left, which of the following would have been true after the exchange?
- I. No one was seated between two persons of the opposite sex. (e.g. no man was seated between two women)
  - II. One side of the table consisted entirely of persons of the same sex.
  - III. Either the host or the hostess changed seats.
- (a) I only
  - (b) II only
  - (c) I and II only
  - (d) II and III only
18. If each person is placed directly opposite her spouse, which of the following pairs must be married?
- (a) Ratan and Monisha
  - (b) Madhuri and Dhirubhai
  - (c) Urmila and Jackie
  - (d) Ratan and Madhuri

**Directions for Questions 19 to 21:** Study the information below and answer questions based on it.

Five of India's leading models are posing for a photograph promoting "y'know, world peace and understanding". But then, Rakesh Shreshtha the photographer is having a tough time getting them to stand in a straight line, because Aishwarya refuses to stand next to Sushmita because Sushmita had said something about her in a leading gossip magazine. Rachel and Anu want to stand together because they are "such good friends, y'know". Manpreet on the other hand cannot get along well with Rachel, because there is some talk about Rachel scheming to get a contract already awarded to Manpreet. Anu believes her friendly astrologer who has asked her to stand at the extreme right for all group photographs. Finally, Rakesh managed to pacify the girls and got a beautiful picture of five beautiful girls smiling beautifully in a beautiful straight line, promoting world peace.



19. If Aishwarya is standing to the extreme left, which is the girl standing in the middle?  
 (a) Manpreet (b) Sushmita  
 (c) Rachel (d) Cannot say
20. If Aishwarya stands to the extreme left, which is the girl who stands second from left?  
 (a) Cannot say (b) Sushmita  
 (c) Rachel (d) Manpreet
21. If Anu's astrologer tells her to stand second from left and Aishwarya decides to stand second from right, then who is the girl standing on the extreme right?  
 (a) Rachel (b) Sushmita  
 (c) Cannot say (d) Manpreet

**2003**

**Directions for Questions 22 to 25:** Answer the questions on the basis of the following information.

Seven faculty members at a management institute frequent a lounge for strong coffee and stimulating conversation. On being asked about their visit to the lounge last Friday we got the following responses.

JC: I came in first, and the next two persons to enter were SS and SM. When I left the lounge, JP and VR were present in the lounge. DG left with me.

JP: When I entered the lounge with VR, JC was sitting there. There was someone else, but I cannot remember who it was.

SM: I went to the lounge for a short while, and met JC, SS and DG in the lounge that day.

SS: I left immediately after SM left.

DG: I met JC, SS, SM, JP and VR during my first visit to the lounge, I went back to my office with JC. When I went to the lounge the second time, JP and VR were there.

PK: I had some urgent work, so I did not sit in the lounge that day, but just collected my coffee and left. JP and DG were the only people in the lounge while I was there.

VR: No comments.

22. Based on the responses, which of the two, JP or DG, entered the lounge first?  
 (a) JP  
 (b) DG  
 (c) Both entered together  
 (d) Cannot be determined
23. Who was sitting with JC when JP entered the lounge?  
 (a) SS (b) SM  
 (c) DG (d) PK

24. How many of the seven members did VR meet on Friday in the lounge?  
 (a) 2 (b) 3  
 (c) 4 (d) 5
25. Who were the last two faculty members to leave the lounge?  
 (a) JC and DG  
 (b) PK and DG  
 (c) JP and PK  
 (d) JP and DG

**Directions for Questions 26 to 29:** Answer the questions on the basis of the following information.

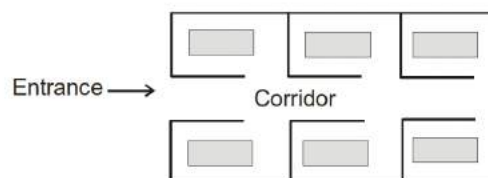

The plan above shows an office block for six officers — A, B, C, D, E and F. Both B and C occupy offices to the right of the corridor (as one enters the office block) and A occupies an office to the left of the corridor. E and F occupy offices on opposite sides of the corridor but their offices do not face each other. The offices of C and D face each other. E does not have a corner office. F's office is further down the corridor than A's, but on the same side.

26. If E sits in his office and faces the corridor, whose office is to his left?  
 (a) A (b) B  
 (c) C (d) D
27. Whose office faces A's office?  
 (a) B (b) C  
 (c) D (d) E
28. Who is/are F's neighbour(s)?  
 (a) A only  
 (b) A and D  
 (c) C only  
 (d) B and C
29. D was heard telling someone to go further down the corridor to the last office on the right. To whose room was he trying to direct that person?  
 (a) A (b) B  
 (c) C (d) F

**2003**

**Directions for Questions 30 to 32:** Answer the questions on the basis of the information given below.

Seven varsity basketball players (A, B, C, D, E, F, and G) are to be honoured at a special luncheon. The players will be seated on the dais in a row. A and G have to leave the luncheon early and so must be seated at the extreme right. B will receive the most valuable player's trophy and so must be in the centre to facilitate presentation. C and D are bitter rivals and therefore must be seated as far apart as possible.

30. Which of the following cannot be seated at either end?
- (a) C (b) D  
(c) F (d) G
31. Which of the following pairs cannot be seated together?
- (a) B & D (b) C & F  
(c) D & G (d) E & A
32. Which of the following pairs cannot occupy the seats on either side of B?
- (a) F & D (b) D & E  
(c) E & G (d) C & F

**MEMORY BASED QUESTIONS****2010**

33. Eight persons – Anu, Bindu, Candy, Dolly, Emran, Fiza, Gauri and Hemant – are sitting at a square table, in the same order, in clockwise direction. Two persons are sitting on each side of the table. Two of them are Managers, two Executives, two Consultants and two Engineers.

The Executives are sitting opposite each other. One of the Executives is sitting on the same side of the table as an Engineer and on his/her left. The Consultants are sitting opposite each other and each of them is sitting next to an Engineer. The Managers are sitting next to each other. If Anu is a Consultant who is sitting next to a Manager, then which of the following statements is definitely false?

- (a) Fiza is an Executive.  
(b) Hemant is sitting next to a Manager.  
(c) Emran is an Engineer.  
(d) None of these

**ANSWERS**

- |         |         |         |         |         |         |         |         |         |         |
|---------|---------|---------|---------|---------|---------|---------|---------|---------|---------|
| 1. (b)  | 2. (b)  | 3. (c)  | 4. (c)  | 5. (a)  | 6. (c)  | 7. (b)  | 8. (d)  | 9. (d)  | 10. (a) |
| 11. (a) | 12. (b) | 13. (c) | 14. (c) | 15. (c) | 16. (d) | 17. (a) | 18. (a) | 19. (b) | 20. (d) |
| 21. (d) | 22. (b) | 23. (c) | 24. (b) | 25. (d) | 26. (c) | 27. (d) | 28. (a) | 29. (b) | 30. (c) |
| 31. (d) | 32. (c) | 33. (d) |         |         |         |         |         |         |         |

**SOLUTIONS****LEVEL - 1**

**For questions 1 to 4 :**

The first statement suggests : B is now as old as C was in the past. Therefore,  $B < C$ . Also sometime in the past, A was twice as old as D. So  $A > D$ . C will be as old as E in future. Hence  $C < E$ .

The second statement suggests :  $A > F$ . A was as old as G in the past. Therefore,  $A > G$ . D will be as old as F in future. So  $F > D$ . F will be as old as G now in future. This implies  $G > F$ . G was as old as B, when A was as old as G. Hence,  $A = B$ .

Combining both the results, we get :

$E > C > B = A > G > F > D$  (Note by  $A = B$ , it is meant that they are of similar age group, not necessarily the same).

1. b It could be figured out that E is the eldest brother.  
2. b D is the youngest brother.  
3. c Only A and B could probably be twins.  
4. c It could be figured out that only statement (c) is false as B has only 2 elder brothers and not 3.  
5. a Since C and D cannot be together, they can occupy either of the following seats: (1st and 3rd), (1st and 4th) or (2nd and 4th). In the last two cases, since B cannot be in the 3rd place, A will have to be there. Thus, we can see that A can never be in the 1st place. Hence, statement (a) is false.  
6. c Since neither A nor B can be at 3rd place, this place has to be occupied by either D or C. And if either of them occupies this place, the other one has to occupy the 1st place (since D and C cannot be together). Hence, C can only occupy either 1st or 3rd place.



7. b If A and B are together, but C and D are not, then the only places that A and B can occupy are 2nd and 3rd. And since B cannot be at 3rd place, A has to be at 3rd place.
8. d According to the given conditions, either Mrs Border or Mrs Dennis can sit to the right of Mr Abraham. It can't be Mrs. Elmer as she sat two places to the right of Mrs. Border.

**For questions 9 and 10:**

If the positions from left to right are 1 to 7

A and G take up positions 6 and 7

B takes up position 4

C and D are in places 1 and 5, so that they are as far as possible.

E and F are in positions 2 and 3.

1	2	3	4	5	6	7
CD	EF	FE	B	DC	AG	GA

9. d

10. a

11. a Since yellow is between green and red, it should be house number 2 or 3. Also green is adjacent to blue house, it should have blue and yellow house on either side. Hence, the following table can be constructed.

House number	1	2	3	4
Colour	Blue	Green	Yellow	Red
Occupant	X		Z	

OR

House number	1	2	3	4
Colour	Red	Yellow	Green	Blue
Occupant		Z		X

Since X does not live adjacent to Z, it has to live in blue house.

12. b Elle is 3 times older than Yogesh and Zaheer is half the age of Wahida.  
If Wahida is  $2x$ -year-old, then Zaheer is  $x$ .  
Now  $\text{Yogesh} > \text{Zaheer}$   
 $\Rightarrow \text{Yogesh} > x$   
Elle is 3 times older than Yogesh.  
This implies Elle is older than Wahida as  $3x > 2x$ .

**Alternative method:**

$$E = 3y \quad \dots(i)$$

$$z = \frac{w}{2}, \text{ or } 2z = w \quad \dots(ii)$$

$y > z$ , implies  $2y > 2z$  implies  $2y > w$  from (ii)

Now, if  $2y > w$

$$3y > w, \text{ i.e. } E > w \text{ from (i)}$$

Hence, Elle is older than Wahida.

13. c From (a) Zaheer is 10-year-old means Wahida is 20-year-old. From (b) Yogesh and Wahida are older than Zaheer by same number of years.

This means Yogesh is 20-year-old. Now Elle is 3 times older than Yogesh.

Elle is  $20 \times 3 = 60$ -year-old.

Hence, we see that both (a) and (b) statements are needed so the answer is (c).

14. c

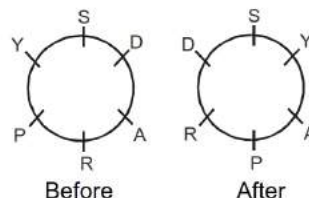

Suresh is sitting to the left of Dhiraj.

**LEVEL - 2**

**For questions 15 to 18:** The correct seating arrangement can be depicted as shown below:

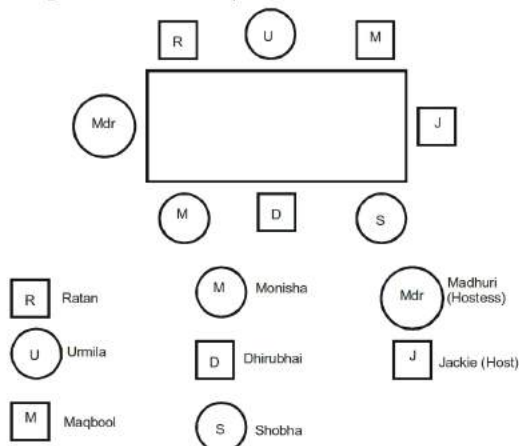

15. c Jackie is the host and also sitting on Shobha's right. Hence (c) is the correct answer.
16. d Shobha is sitting next to Jackie and Dhirubhai. So she is the only person who is not seated next to a person of the same sex.
17. a If Ratan would have exchanged seat with a person four places to his left, which is Shobha, the following arrangement would exist.

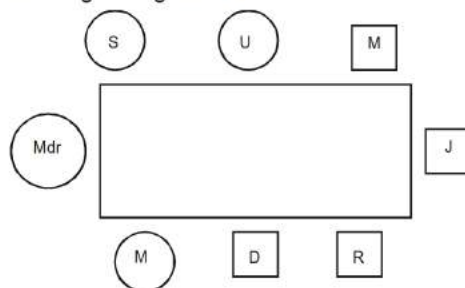

The first statement is hence true, since no man is sitting between two woman and no woman is sitting between two man. However statements II and III are not true. Hence the answer is (a).

18. a Among the given choices, only Ratan & Monisha are sitting opposite to each other and hence they must be married.

#### For questions 19 to 21:

From the given conditions the only arrangements that are possible is

Left		Right		
Sushmita	Manpreet	Aishwarya	Rachel	Anu
1	2	3	4	5

Left		Right		
Aishwarya	Manpreet	Sushmita	Rachel	Anu
1	2	3	4	5

19. b If Aishwarya is standing at the extreme left, the latter arrangement holds good. Hence it is Sushmita who is standing in the middle.
20. d Again the latter arrangement holds good. So the girl who is standing second from left is Manpreet.
21. d Under the given condition, following arrangement is possible:

Left		Right		
Sushmita	Anu	Rachel	Aishwarya	Manpreet
1	2	3	4	5

Hence Rachel is standing on the extreme right.

#### For questions 22 to 25:

JC came in first and the next 2 people were SS and SM. When he left, DG left with him. JP and VR stayed behind.

Entry	Exit	Met
JC → SS → SM	JC and DG	JP and VR
JP and VR together		JC and one more person

SS left immediately after SM.

PK only met JP and DG.

The key to this question is that when JP and VR entered apart from JC there was only one other person. This could not have been SS or SM as they came and left together. Hence, this would have to be DG.

Hence, DG came 4<sup>th</sup>, before JP and is the answer to both 143 and 144.

Now for Qs 145, we need to see how many people VR met. Both SS and SM had already left and JC and DG

were sitting. He entered with JP eliminating 2 and 5 from our answer choices. Since PK did not meet VR, the answer is 3 and not 4.

22. b

23. c

24. b

25. d

#### For questions 26 to 29:

	D	A	F
Entrance	Corridor		
	C	E	B

26. c If E faces the corridor, person to his left is C.

So the answer is (c).

27. d According to figure, E faces A's office.

So the answer is (d).

28. a According to figure, F's neighbour is A.

So the answer is (a).

29. b According to figure, B's room is last on the right.

So the answer is (b).

#### For questions 30 to 32:

1	2	3	4	5	6	7
C			B	D	A	G
D			B	C	A	G
C			B	D	G	A
D			B	C	G	A

30. c From given options, F is the only possibility.

31. d If we look at the options, D and G can sit together. C and F can sit together B and D can sit together. Hence, E and A is the only option which is not possible.

32. c E and G is the only possibility.

33. d Let Anu, Bindu, Candy, Dolly, Emran, Fiza, Gauri and Hemant be represented by A, B, C, D, E, F, G and H respectively. The only possible arrangement is shown below.

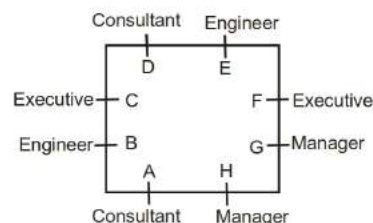

Hence, none of the statements is false.